



## Parrilla M 902 Technical Data Sheet



### Available Sizes

Braseiro	Grill Area
12"	20"
15 "	24"
	27"
	31"
	35"
	39"

### Features

The Parrilla M 902 is a classic model of Argentine Parrilla , made of stainless steel , with front wheel winder for manual control of the height of the grill. - It is equipped with stainless steel V grills with grease tray or round stainless steel grills, both of which are easy to remove for cleaning. - This Parrilla accepts firewood or charcoal, which must be burned in the brazier and, later, the embers are spread under the grills. - Options include the addition of upper bar with stainless steel hooks.

### Optional Accessories



Coal Spreader



Brass Brush

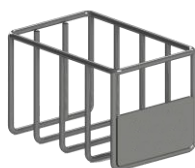

Braseiro



### Whats Included

V-grill with grease tray or round grate, on request.  
Top rest grill. Side brazier coupled with stainless steel door for thermal insulation.

Masonry

Depth: 21 3/4" Other dimensions available on request.

### Technical Specifications

INSTALLATION: Masonry.

MATERIAL: Stainless steel 304, stainless steel 430, carbon steel brazier.

WEIGHT: varies by measurement and packaging.

GRILL SYSTEM: grill with manual height control via front wheel winder, with anti-reverse technology.